

Chandler Workspace - BRC

140003-083

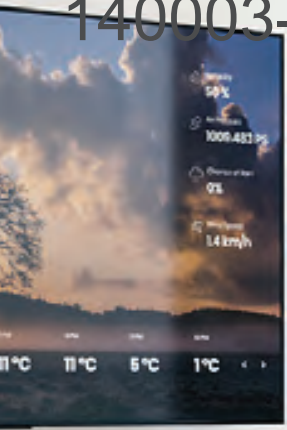

NOVA  
RECTANGULAR



height adjustable tables

**abrc**  
brc.group

natural and more.

private & executive office | management office | storage  
open space | boardroom | panel | lounge area





# TABLES

MEETING & CASUAL  
CONFERENCE & MEDIA

---

## Engineered for Functional Purposes

Our meeting and casual tables are available in different table tops and base styles. They come in various heights to accommodate for sitting and for standing positions. We can customize your table design to suit your personal and office needs.



YORK  
Y BASE

Also available in Flip Top Table, Prime T Base, Tubular T Base, Tubular T Base on casters, and Post Legs.



FIT  
SQUARE TOP

Also available in Prime X Base, Square Nova, Arced Square Nova, Disc Base, Tubular X Base, and Tubular X Base on casters.



YORK X BASE  
SQUARE TOP



YORK  
Y BASE 29" HEIGHT



TRAPEZOID BASE  
PERSONAL TABLE 26" HEIGHT

Also available in C Base Personal Table



DISC BASE  
ROUND TOP 42" HEIGHT

Also available in Prime X Base on casters,  
Round Fit, Round Nova, Tubular X Base, and  
Tubular X Base on casters.

O LEG  
DESK



Also available in C Leg and A Leg Desk.

NEST  
FOLDABLE TABLE

Nest Tables come with power modules, modesty panels and rubber locking wheels. Available in 60" or 72" long and 24" or 30" deep.



BOND  
TABLE



Bond Table is available in 24" x 48" or 54" x 60"

CONFERENCE TABLES

---



FIT  
RECTANGULAR

Also available in Arc End Rectangular, Racetrack, Arched Boat, Trapezoid, and BRC fit.





NOVA  
RECTANGULAR

## Design & Technology Integrated

Our conference tables are designed with boardroom elegance in mind. Clean lines are emphasized, and modesty panels are used to hide any electrical outlets and cables out of sight. With many options and extras to choose from, our tables are truly a high-performing product that will bring style and distinction to your boardroom meetings.

### ELECTRICAL SOLUTION



Also available in Arc End Rectangular, Racetrack, Arched Boat, Trapezoid, Oval and BRC fit.



Seoul



Toronto



Berlin



NOVA  
RECTANGULAR WITH 3 BASES

MEDIA TABLE

---

RECTANGLE  
MEDIA TABLE



Also available in Bullet Media and Trapezoid

PARSONS  
TABLE



CONFERENCE TABLES: FIT & NOVA BASE TABLES

Fit Base Tables

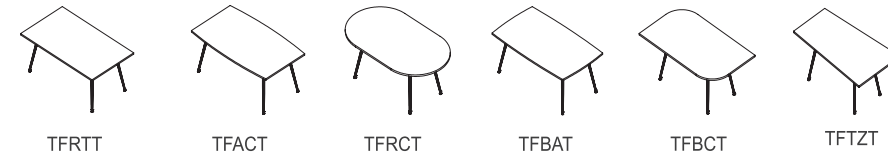

Rectangle Nova Base Tables

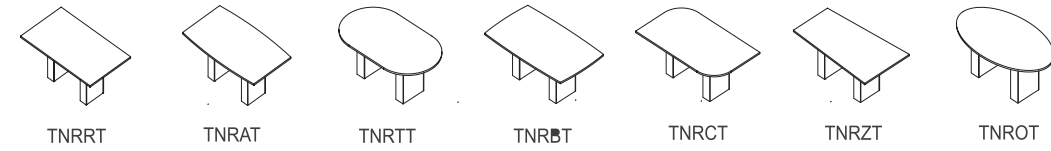

Triangle Nova Base Tables

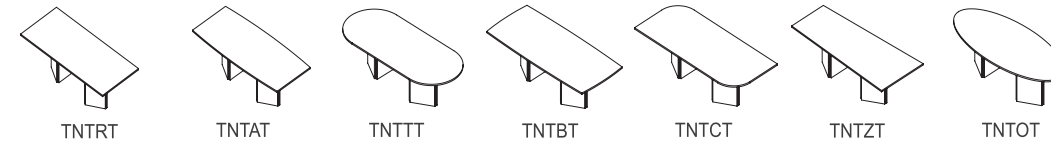

Disc Base Tables

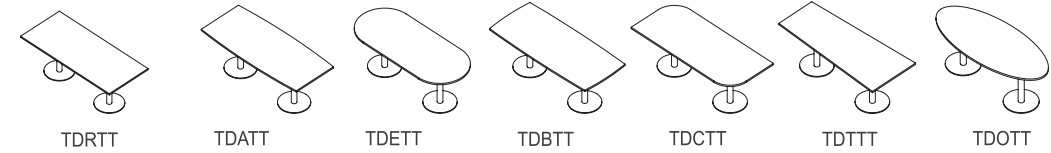

Meeting Tables: Fit and Nova Base

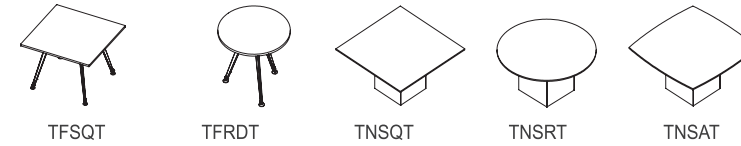

MEDIA TABLES

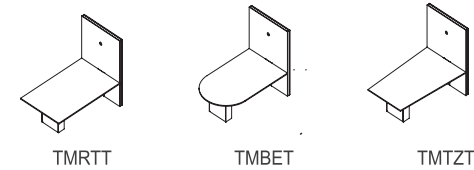

PARSONS TABLES

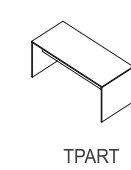

MEETING & CASUAL TABLES

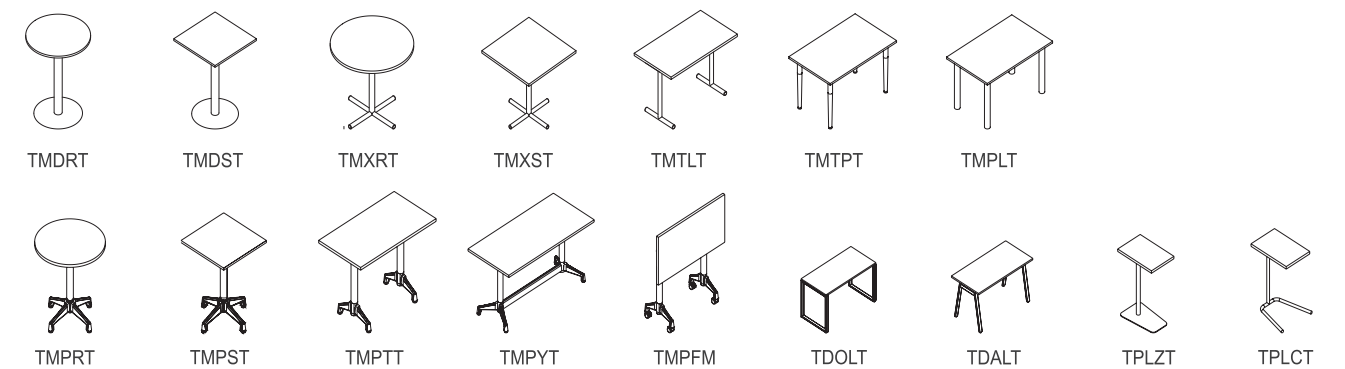

DISC BASE  
RACETRACK TABLE



Also available in Rectangular, Arc End, Arched Boat, Trapezoid, Oval and BRC fit.





## Tables Price Guide

---

BRC Group of Companies  
24 Armstrong Avenue, Georgetown, Ontario, Canada L7G 4R9

[www.brc.group](http://www.brc.group)

Tel: (905) 873-8509    Toll Free: (877) 260-4309  
Fax (905) 873-9165    E-mail: [info@brc.group](mailto:info@brc.group)

Final products, including finishes and colours may not be exactly as represented in the catalogue. BRC reserves the right to modify the product without notification at any time.

☒ BRC provides creative and innovative solutions to complement any environment and use. Flexible manufacturing offers the ability for BRC to respond to a client's custom needs in addition to having standard catalogue solutions. A wide collection of textiles, laminate finishes and wood veneer allows companies and individuals to express their brand and culture through a unique signature look.





private & executive office | management office | storage  
open space | boardroom | panel | lounge area

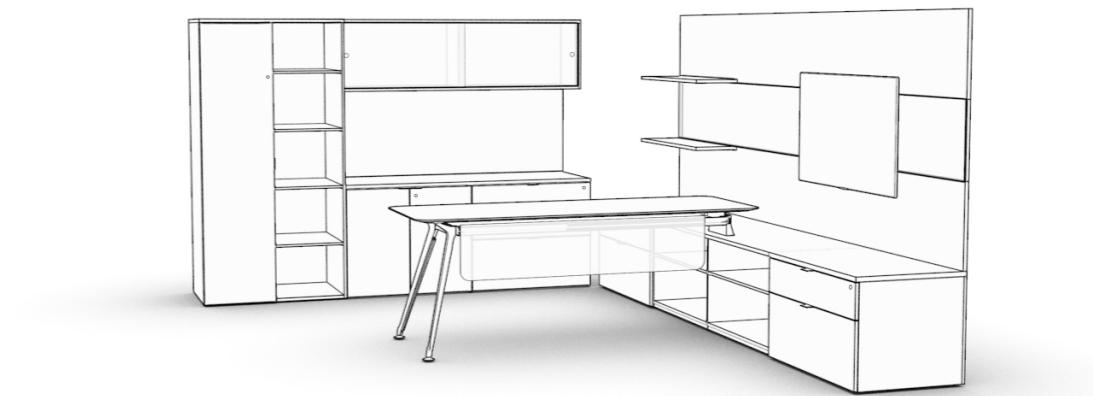

BRC's **Natural** Series is available in a multitude of sizes with low pressure and high pressure laminate choices with matching flat edge detail. Optional knife edge is available. BRC offers over 35 standard finish options in solid laminate and woodgrain, including anti-microbial laminate and more than a dozen power options from our accessories catalog





Image above: Executive suite with a low storage, floating desk with a full wardrobe and overhead storage finished in Hardrock maple & Nova white.\*



Top Image : A sophisticated and clean design includes a height adjustable desk with integrated cabinet and various storage. Finished in Hardrock maple & Nova white.\*  
Bottom Image: This design layout that uses a post leg and low storage that can be used for seating. Finish is Mimosa allover.\*



natural  
executive office

Shown above: Natural series Private office includes an overhead wall mounted storage, desk with an inserted panel on the leg, a low credenza and a regular height credenza  
Finish: Azabache allover with black leg frame



natural  
executive office

Image above: Nolita desk with a suspended wall unit. \*  
Finish: Mimosa with Platinum



Top Image: A complete open suite with a combination of Natural storage  
and a Fit desk arrangement. \* Finish: Hardrock Maple and Nova White  
Bottom Image: Clean and seamless executive office design.  
Finished in Siroko laminate all-over



Shown on this page: A series of typicals showcasing the variety of Natural executive office designs. From a simple layout design to large suites with a extensive options on finishes, handles, legs, fabric and power.



Above Image: A classic layout with a minimalistic design creates an elegant executive suite. Finished: Nova White & Denver laminate.



Top Image: A combination of Natural & Fit are used in this layout. \*  
 Bottom Image: A u-shape unit finished in a ginger root. \*

Notes: All items shown with a \* is considered custom for the time being.



Top Image: Nolita height adjustable desk with low storage, overhead and wardrobe storage.  
Bottom Image: A simple 3 piece arrangement includes a separate desk. \*

Top Image: L-shape suite with overhead storage and a full height wardrobe.  
Bottom Image: Soho height adjustable desk

Top Image: Executive suite with a integrated desk.\*  
Bottom Image: Viva height adjustable desk with various Natural storage.

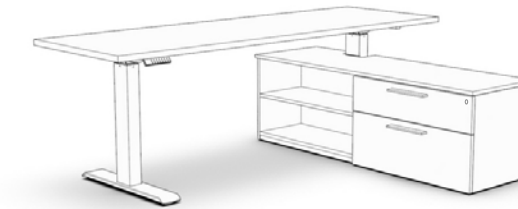
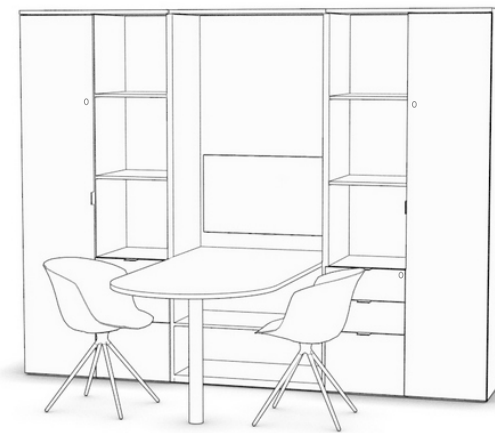
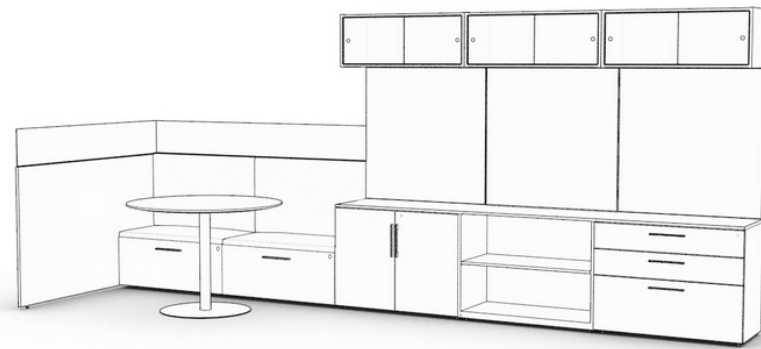
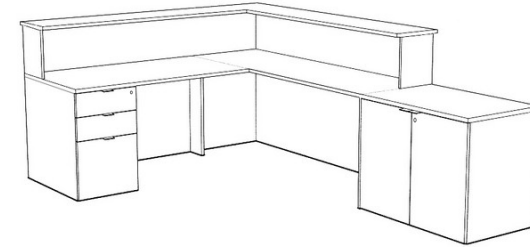

Top Image: Semi open space layout consisting a back to back desk layout with storage and panels for privacy.  
Bottom Image: 3 pieces cabinet creating a single unit incorporating a desk. \*

Top Image: Natural reception desk with storage.  
Bottom Image: 3 pieces cabinet creating a single unit incorporating a desk. \*

Top Image: C-shape side by side desk arrangement with overhead hutches.  
Bottom Image: Alta height adjustable desk with integrated credenza.

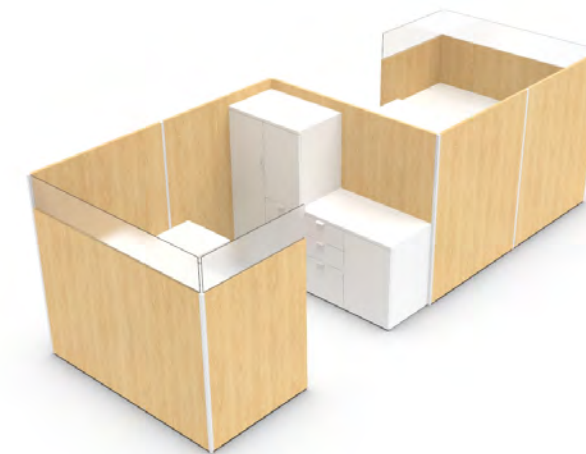
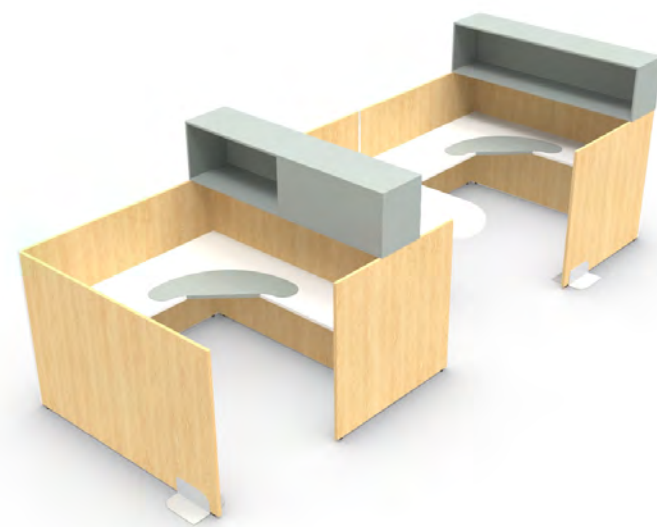

Top Image; Integrated panels & storage \*  
Bottom Image: Dividers & privacy screens



natural  
fit table series



Fit table series includes various shapes, sizes and finishes.

Notes: All items shown with a \* is considered custom for the time being.



Top row: Fit table series  
Centre row: Disk base table series\*  
Bottom row: Architectural table series



Top Image: Bar height table with o-leg and integrated lockers.\*

Bottom Image: Bank of lockers ganged together with a bar height table.\*

Top 3 Images above: Power options available  
Bottom Image: Bag hook option

Top & Bottom Image: Bar height tables are available with various storage, leg and power options.\*



Top Left Image: Planters integrated with bar height lockers\*  
Top Right Image: Natural family of lockers available in several sizes and lock options.  
Bottom Images: Waste cabinet series comes in a number of configurations.\*

natural  
classic & contemporary



BRC has an extensive offering of accessories.  
To see more products visit our website accessories  
catalogue & guide .

Our design & marketing team is constantly researching  
and developing new products and concepts.  
Reviewing the latest materials and finishes to include in  
our offerings.

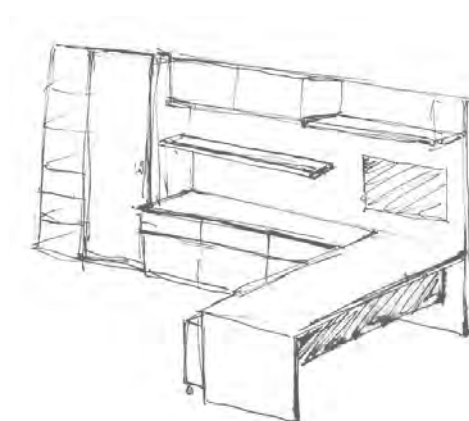

Top Image: A Natural classic desk design.  
Finish: Mimoso and black  
Bottom Image: This suite keeps all storage separate which  
allows to be reconfigured if required.  
Finish: Inspiration and black

natural  
beyond open concepts



Touch down station



Top Image: The Natural series offers a number of leg options from an O-legs, A legs, posts and height adjustable legs\*  
Bottom Image: Storage and meeting space all in one.\*

Notes: All items shown with a \* is considered custom for the time being.



Top Image: Back to back height adjustable desk and integrated credenzas can create a unique benching solution.\*  
Bottom Image: C-shape reception desk with storage.

Bottom Image: A simple benching solution is created using a work surface with a credenza and a Manhattan tower.\*

Top Image: Single sided A-leg mounted to panels creating a clean light design for a benching solution.\*  
Bottom Image: 3 piece storage and a desk creates an ideal executive suite or a gathering spot.\*



24 Armstrong Ave.  
Georgetown, ON L7G 4R9  
T: 905.873.8509  
Toll Free: 1.877.260.4309







Items Shown: Viva fixed height on left and electric table on right in Finesse laminate with White base.

## Introduction

BRC's Emotion series is a tested and proven height adjustable solution both in the lab and in the field. The product has sustained over 20 years of success and during that time undergone constant refinements and improvements. Rugged construction and reliable electronic components have been tested and certified to ANSI BIFMA & CGSB standards assuring the highest quality.

## A workstation for everyone

Stationary desks and workstations present a problem to natural instinct. The human body is designed to benefit from motion which is important for spinal health, improving circulation and reducing muscle fatigue. Height adjustable tables can encourage movement by offering the user multiple sitting and standing positions.

Another benefit is the ability for the user to adjust the desk to the optimal working height for their body both in a sitting and standing position. Even two people who are the same height may have different resting elbow positions and in turn prefer different sitting and standing heights. The benefit is that a workstation can accommodate virtually all users at a cost that is only marginally higher than a fixed height desk. In turn providing the user an opportunity to break their static posture without leaving the work area.

Height adjustable tables can also provide an inclusive atmosphere for everyone. BRC's line of Mesa and Viva height adjustable electric desks provide a modesty free ADA solution that is wheelchair accessible. In addition, both product lines offer a collision free mechanism that stops table movement when resistance is encountered, preventing injury.







# Mesa

## Economical electric height adjustability

With the push of a button, Mesa can move from sitting to standing, and everywhere in between. Style and design meet effortless adjustment and sturdy design. Mesa is BRC's most affordable height-adjustable table.

### Features:

- Height adjustment from 22.75" to 48.50"
- Dual motor with a lift capacity up to 275lbs
- Power rated at 456W, 3.8 Amp working, 0.5W standby
- 108" Power cord length
- Worksurface 1" LP laminate or HP laminate in all standard BRC laminates
- Lifting columns, trim & frame in powdercoat silver, black or white
- Programmable Anti Collision enabled: - table will stop if obstruction is encountered
- Fully adjustable width frame virtually eliminates lateral movement
- Modesty free design meets ADA accessibility requirements
- UL Certified electronics



## Right at home

With work patterns shifting to transient or home based offices, ergonomics and healthy working postures are just as crucial as they were in the traditional office. BRC height adjustable desks and storage accessories make a great combination while providing the same user friendly design. ANSI-BIFMA testing ensures that commercial grade quality BRC products will perform just as well at home as in the office. In addition, BRC has a wide range of laminate and edge finishes tailored to fit the home decor, including antibacterial surface options. A carefully selected range of handle options and colours allows the client endless possibilities.

## Tailor the space

If the standard offering doesn't fit the space, BRC can design and build a custom solution to suit the clients requirement. Our laminate design and expertise is far reaching, let us know your challenge and we can make it work.

# Viva

## Research based height adjustability

Viva is bred from over 30 years of furniture manufacturing experience, including a timeless, adaptable array of excellent quality ergonomic tables and workstations. Viva offers a highly engineered low profile foot which is constructed of drawn steel, with waterfall front and back edges. All tables are optionally available with casters, wire management, ganging systems, floating monitor platforms, keyboard platforms, modesty panels and other accessories.

### Features:

- Superior quality tables
- Barrier-free access
- Optional floating modesty panel
- 24" - 36" height range for manually operated
- 22" - 48" height range for electric
- 300 lbs electric lift capacity with 1.5" per second travel
- Meets or exceeds ANSI/ BIFMA standards
- Custom configuration and capabilities to suit any workstation
- Bluetooth, battery operation & App, remote control available





Available finishes include all of BRC's standard LP and HP laminate options. Base colour is available in black, silver and white powder coat. The Viva line features a matching foot base in electric, manually operated, incremental and fixed height table. Viva electric can be optioned with bluetooth functionality which integrates with an iOS and Android app.

The app can be configured to save custom heights or create a health plan that reminds you when to stand if you've been sitting for too long. Additional options include a rechargeable battery for cord free operation and multiple handset variations.



# SoHo

## Adjustable height design at its best

BRC is taking health-positive movement to a new level with this attractive adjustable-height desk that moves seamlessly and quietly from sitting to standing.

The Emotion product line SoHo includes a new executive base format for a clean, sharp, ergonomic solution for managerial applications. SoHo features an advanced control handset that allows users to track how many minutes and calories they accrue by standing during the day. An alarm function also reminds users when it's time to stand.

### Features:

- Floating modesty panel
- Moves seamlessly and quietly from sitting to standing
- 1 box / 1 file pedestals on each side
- 350 lb lift capacity
- Multiple handset controller options
- Range from 26" to 52"
- 84" x 30" deep, 4" tall legs
- Custom sizes available



# NoLita

NoLita is BRC's newest electric height adjustable table. Ideally suited for private office providing an enclosed frame, reduced foot space and integrated modesty panel available in frosted or patterned screen. NoLita can also be used as an open plan meeting table with option for both surfaces to be height adjustable.

*Items Shown: NoLita Height Adjustable Table with Storm base, Mimosa worksurface and black frame. Custom designed wall mounted storage and shelving in Mimosa laminate with white back painted glass; contact BRC for details.*



# Executive decision

Now the executive private office can have the same health benefits that open plan height adjustable tables offer. Hidden frame and mechanisms contribute to a clean aesthetic while providing an upscale environment.





Items shown: SoHo table in Nova White with Ginger Root fronts & modesty. BRC storage behind in matching laminate.

## Desk Control app



Viva Desk Control App:

- Up & down control
- 4 memory positions
- Height display
- Tracks usage
- Issues standing reminders
- Works with Bluetooth
- Desk control app compatible
- Displays error codes & links to support website



## Accessories

### Controller options

#### Viva



Basic height control: DPG1K

- lift up to raise, push down to lower
- Standard with all Viva product



Advanced height control: DPG1B

- lift up to raise, push down to lower
- 2 memory positions
- LED light strip reminder
- Bluetooth
- Desk control app compatible
- Optional on all Viva product



Full feature height control: DPG1C

- lift up to raise, push down to lower
- 4 memory positions
- Digital height display
- LED light strip reminder
- Bluetooth
- Desk control app compatible
- Optional on all Viva product

#### Mesa

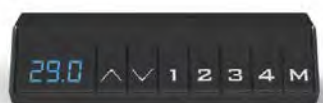

Standard height control:

- Up and down momentary buttons to control height
- 4 Memory positions
- Digital height display in metric or imperial



Single monitor arm:

- Multi directional
- Integrated wire management
- Clamp on or grommet mount



Dual monitor arm:

- Multi directional
- Integrated wire management
- Clamp on or grommet mount



Wire snake:

- Weighted base
- Black or Silver
- Ease wire routing



CPU holder:

- Under worksurface mount
- 85lb Load capacity
- All steel construction

# Laminate finishes

## Standard

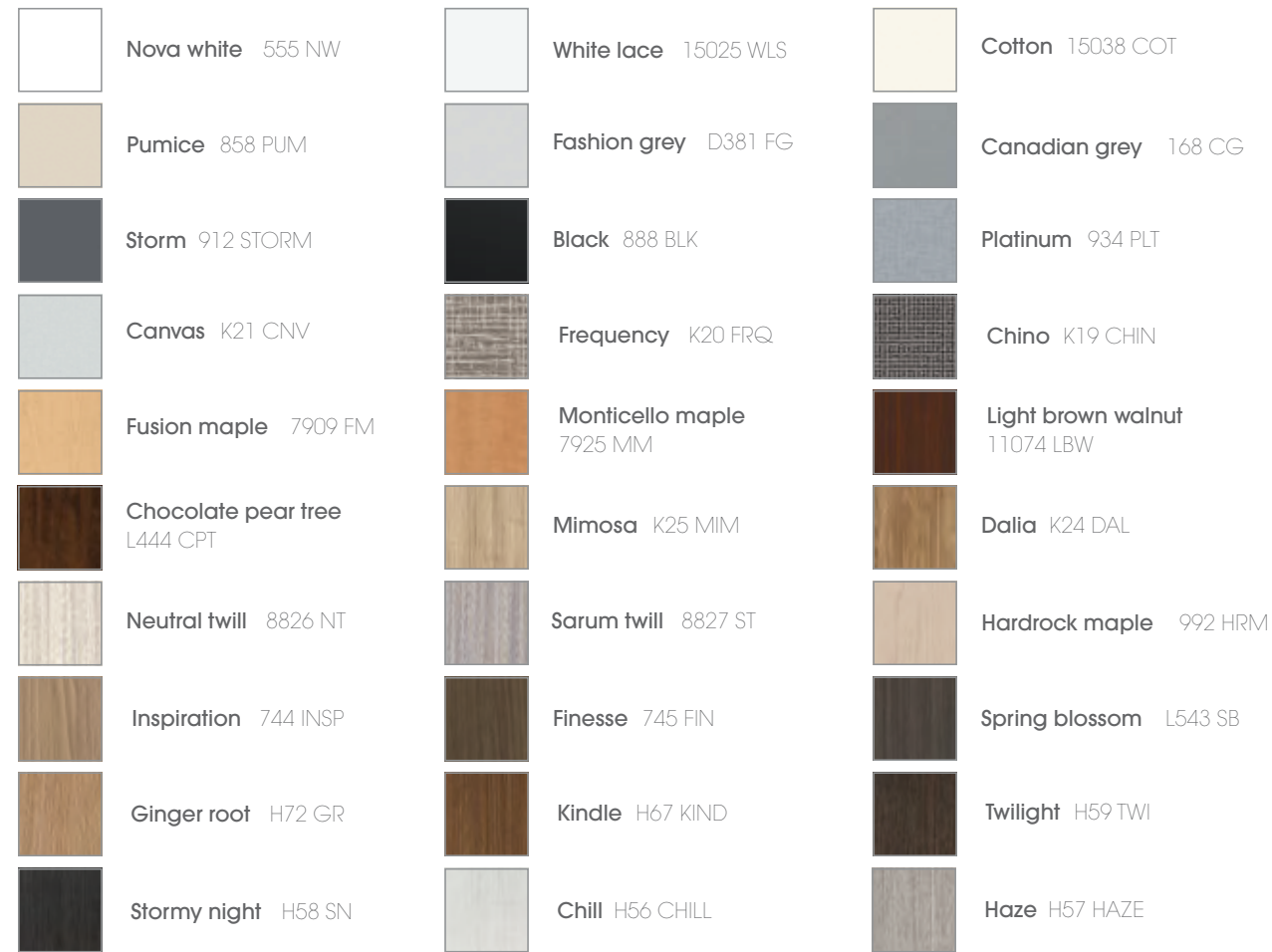

## Metal



Visit [www.brc.group](http://www.brc.group) to see representative samples of our complete textile and materials offering or request samples.

### Contact information

To place an order please contact BRC directly or your local area representative.

BRC Group  
24 Armstrong Avenue  
Georgetown, Ontario L7G 4R9

Direct: (905) 873-8509 Toll-free: 1-877-260-4309 [www.brc.group](http://www.brc.group) [info@brc.group](mailto:info@brc.group)

# Thank you for considering BRC

## Built in North America

Established in 1979 and incorporated in 1983, the BRC Group has grown into a leader in the research, development and manufacturing of high quality ergonomic furniture and architectural walls. BRC is a Canadian owned private company with modern manufacturing facilities in Georgetown, Ontario, Canada.

All materials are both regionally and internationally sourced, assuring that only the best raw materials are converted to finished goods. BRC is committed to developing and offering the best-value products for the middle to higher end markets.

## Tailored products

From obscure designer requests to simply trying to be better, BRC provides creative and innovative customized solutions to complement any environment and use. Flexible manufacturing offers the ability for BRC to respond to client's special custom needs rather than having standard catalogue solutions. A wide collection of textiles, laminate finishes and wood allows companies and individuals to express their brand and culture through a unique signature look.

## Reliable construction

All furniture is designed and manufactured to meet and exceed ANSI-BIFMA standards. Standard construction uses a combination of 3/4 and 1" material with optional 1-1/2" tops and metal to metal connections for a solid long-lasting construction. The newest edge banding technology, in which the edge tape is melted directly to the edge of their board, enables BRC to manufacture products with virtually invisible glue lines.

## Design and production in a sustainable way

BRC is a forerunner in blending environmental initiatives with the manufacturing of renewable and recyclable products. The sustainability and recyclability of the products are indispensable requirements as for quality of materials, versatility, utility and ergonomics. BRC uses materials and manufacturing processes which reduce Volatile Chemical (VOC) emissions in the office environment.

## Price List

<https://brc.group/resources/government/>

## Finishes

<https://brc.group/resources/finishes-materials/>